



ZONING COMMISSION PUBLIC HEARING  
SQUARE 1736 + 1732 | LOT 0045 + 0049 • WASHINGTON, D.C.

09.28.2017







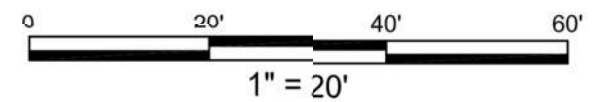
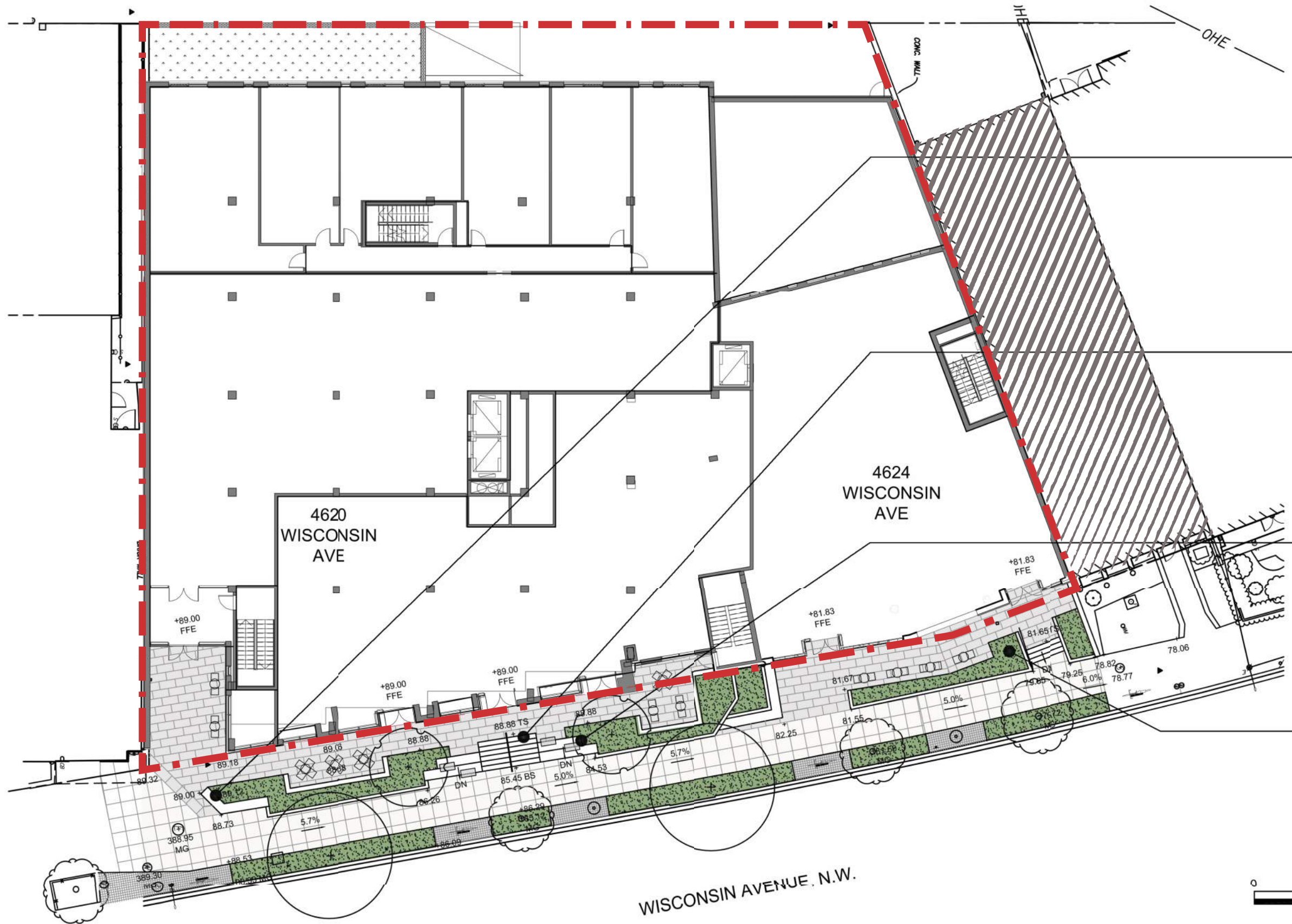



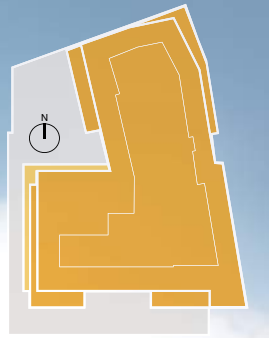

4620-4624 WISCONSIN AVE NW  
 SQUARE 1736 + 1732 | LOT 0045 + 0049 • WASHINGTON, D.C.

A4  
 09.28.2017





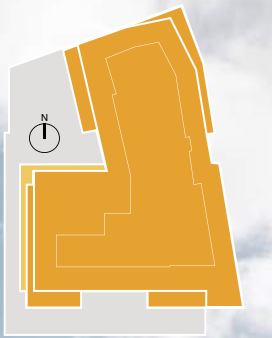

4620-4624 WISCONSIN AVE NW  
 SQUARE 1736 + 1732 | LOT 0045 + 0049 • WASHINGTON, D.C.

A5  
 09.28.2017





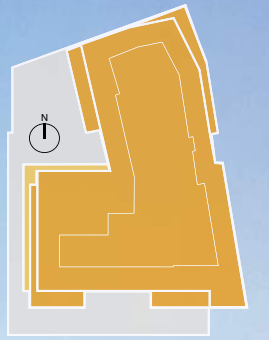

4620-4624 WISCONSIN AVE NW  
SQUARE 1736 + 1732 | LOT 0045 + 0049 • WASHINGTON, D.C.

A6  
09.28.2017





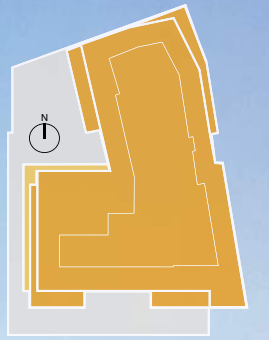

4620-4624 WISCONSIN AVE NW  
 SQUARE 1736 + 1732 | LOT 0045 + 0049 • WASHINGTON, D.C.

A7  
 09.28.2017







CURRENT SITE ELEVATION DESIGN









EXISTING PHOTO



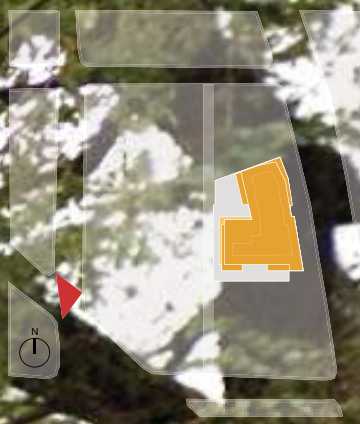





EXISTING PHOTO



